



LEGEND

- Topographic Contour (1m interval)
- Topographic Contour (5m Interval)
- Site Boundary
- Cross Section Location
- Tree Planting

RECEIVED
19 DEC 2008
COMMUNITIES DEPT.

NOTES:
 All Levels in metres above Ordnance Datum
 Based on drawing Plan 6b provided by MSS.
 Please refer to Drawing No. JA.387-3b for cross section details

DRAWN	RJB
CHECKED	DABH
	STD

SITE
REVISED PLANS
RATCHER HILL QUARRY
Additional plans

PLAN
FINAL RESTORATION PLAN

Scale: 1:2500 @ A3 Date: 12.03.08

Plan Ref. No. JA.387-2a



JAMES
 associates
 Geological, Mining and Development Consultants
 Snitterton House, 3 Snitterton Road,
 Matlock, Derbyshire, DE4 3LZ
 T: 01629 581389 F: 01629 580007
 E: jamesassociates@tiscall.co.uk

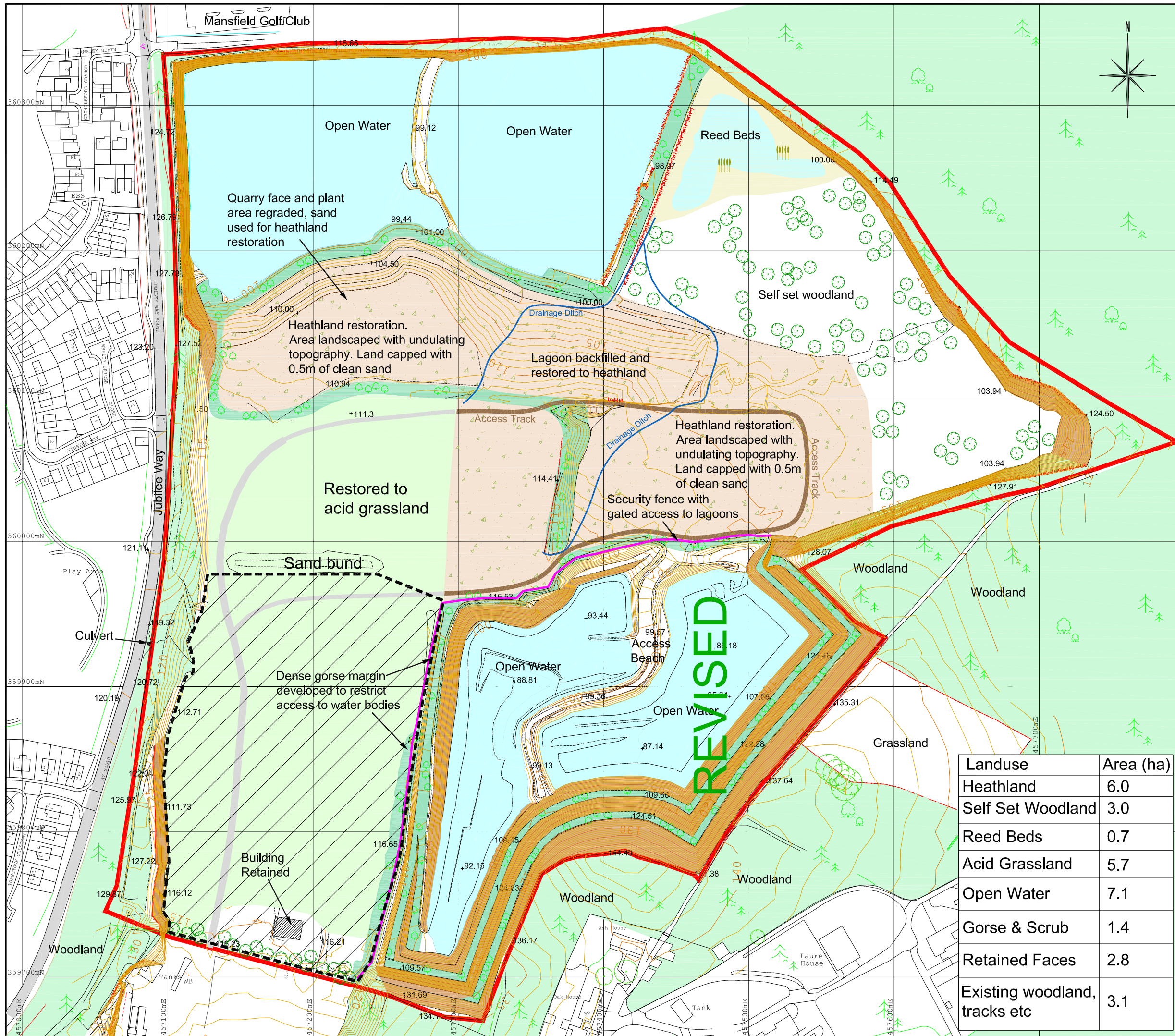

- KEY**
- Quarry Planning Permission
 - 161
— 160 Contour (mAOD)
 - Proposed Acid Grassland
 - Existing Reed Beds Retained
 - Proposed Heathland
 - Existing Woodland
 - Proposed Woodland
 - Retained Quarry Faces
 - Gorse & Scrub
 - Proposed Industrial Area
 - Approximate Location of Security Fence

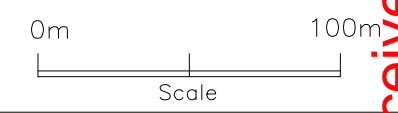

Notes
 Site surveyed by Greenfield Associates January 2008
 Site surveyed by Peak Surveying Services May 2016
 Extraction area updated May 2016.

Based upon 2003 Ordnance Survey 1:2500 digital base with the permission of The Controller of Her Majesty's Stationery Office. © Crown Copyright. All rights reserved.
 Greenfield Associates, 1 Commercial Road, Keyworth, Nottingham, Licence No. 100020449

The copyright of this drawing and its contents are the sole property of Greenfield Associates and must not be copied, or shown to third parties without prior consent of the Company or its clients.

Site
Ratcher Hill Quarry

Project
Quarry Restoration

Title
**Proposed Quarry Restoration
 Phase 1 - September 2017**

Landuse	Area (ha)
Heathland	6.0
Self Set Woodland	3.0
Reed Beds	0.7
Acid Grassland	5.7
Open Water	7.1
Gorse & Scrub	1.4
Retained Faces	2.8
Existing woodland, tracks etc	3.1

Scale 1:2,500 @A3
 Project No. MSF/TOF/116
 File: RH Restoration Design Phase 1 Rev 9.dwg
 Drawn by: DJR Date: 08/05/2018

Greenfield
associates
 1, Commercial Road, Keyworth, Nottingham, NG12 5JS.
 E-mail: admin@greenfield-associates.co.uk
 Tel: (0115) 937 2002

IFC Received
 16/05/2018